

下水道用マンホール側塊

JISA5372

両斜壁

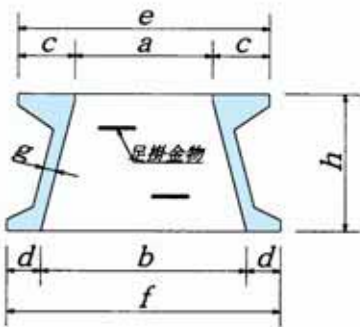

片面斜壁

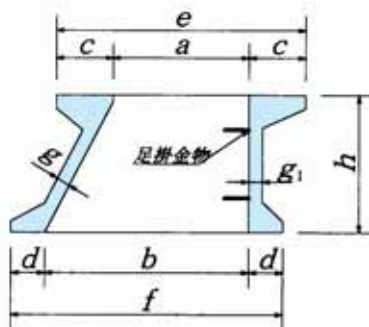
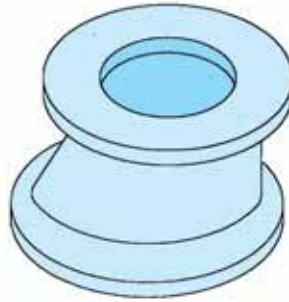

直壁

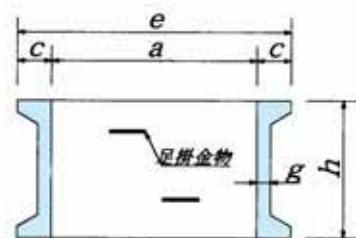
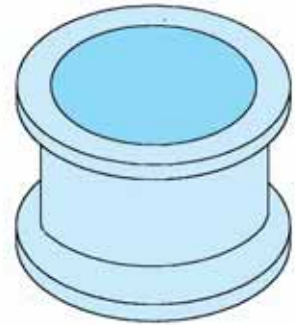

呼び名	寸 法 表 (mm)										参考重量
	a	b	c	d	e	f	g	g ₁	h		
両斜壁	600A	600	900	250	150	1,100	1,200	60	—	300	318
	600B	600	900	250	150	1,100	1,200	60	—	450	370
	600C	600	900	250	150	1,100	1,200	60	—	600	423
	600D	600	1,200	250	150	1,100	1,500	70	—	600	539
片面斜壁	600B	600	900	250	150	1,100	1,200	60	60	450	382
	600C	600	900	250	150	1,100	1,200	60	60	600	460
	600D	600	1,200	250	150	1,100	1,500	90	70	600	620
直壁	900A	900	—	150	—	1,200	—	60	—	300	244
	900B	900	—	150	—	1,200	—	60	—	600	374
	1200A	1,200	—	150	—	1,500	—	70	—	300	326
	1200B	1,200	—	150	—	1,500	—	70	—	600	527